



### Tools



Included:  
1 x Wide Strip  
1 x Click strip  
Fixings

All dimensions in mm

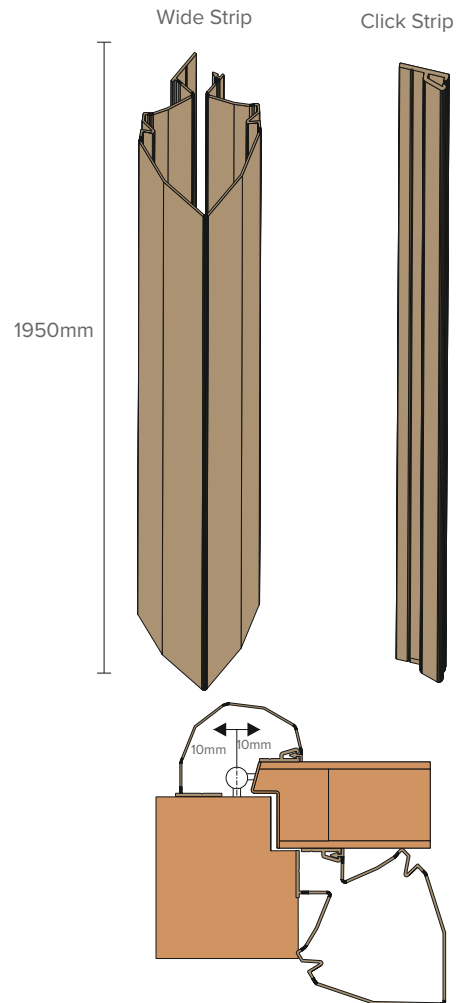

### 1

1.1

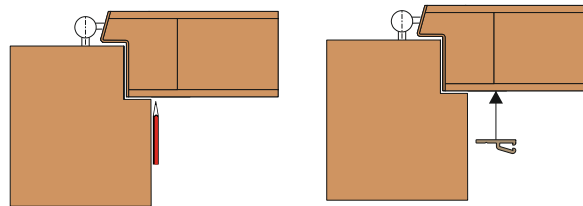
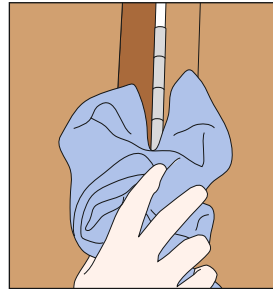

**1.1** Clean and dry the door and door frame thoroughly.

**1.2** With the door closed using the frame as a ruler draw a line from top to bottom of the door.

**1.3** Peel off the self adhesive backing from the click strip and fix to the door using the previously drawn line as a guide, fix from bottom to the top starting 15mm from the bottom of the door pressing firmly up and down on the strip for 2 minutes. If fitting to a wooden door screw into place using the pre-drilled holes and screws provided.

### 2

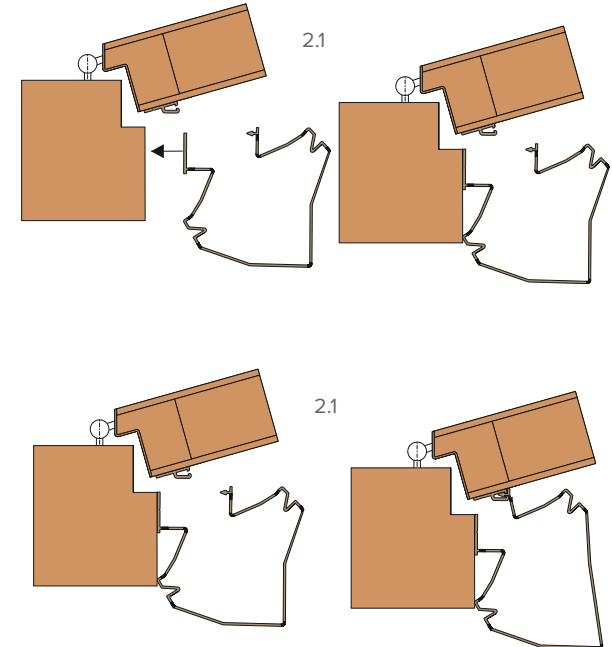

**2.1** Open the door slightly and secure. Peel off self adhesive backing from the wide strip and fix to the frame starting 15mm from the bottom and keeping flush with the edge of the door pressing firmly up and down the strip for 2 minutes. If fitting to a wooden frame screw into place using the pre-drilled holes and screws provided.

**2.1** Push the other side into the click strip firmly ensuring the full length is clicked into place.

### 3

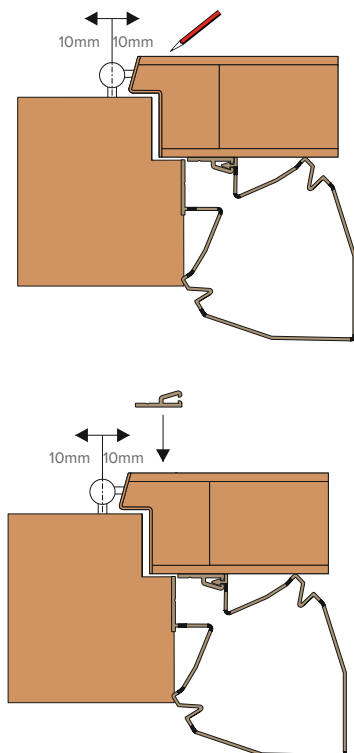

**3.1** Measure 10mm from the centre of the hinge barrel and draw a line the full length of the door.

**3.2** Peel off the self adhesive backing from the click strip and fix to the door using the previously drawn line as a guide, fix from the bottom to the top starting 15mm from the bottom of the door pressing firmly up and down on strip for 2 minutes. If fitting to a wooden door screw into place using the pre-drilled holes and screws provided.

### 4

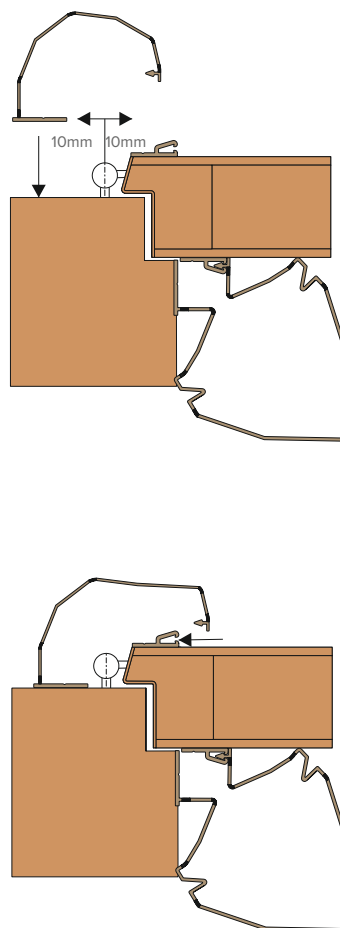

**4.1** Peel off the self adhesive backing from the narrow strip and fix to the door using the previously drawn line as a guide, fix from the bottom to the top ensuring the strip is 15mm from the bottom of the door pressing firmly up and down on strip for 2 minutes. If fitting to a wooden door screw into place using the pre-drilled holes and screws provided.

**4.2** Push the other side into the click strip firmly ensuring the full length is clicked into place.

