

Tools

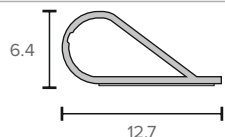

Included:
NOR 788 Seal



Read before installation! Failure to do so may result in improper adhesion.

Storage and shelf life: All adhesive gaskets have a limited shelf life.

This product must be used within 6 months of purchase and must be stored between 50°F and 100°F.

Before installing: Thoroughly clean the frame with the enclosed cleansing towelette to remove grease, dust or cleanser build-up. Before installation, wait for frame surface to completely dry (evaporate). Some hospital environments have wax or anti-bacterial cleanser build-up. As an alternative or substitute cleanser, use isopropyl (rubbing) alcohol. Note: Mineral spirits or other petroleum based cleaning products should NOT be used.

Application temperature: If frames are too cold (below 50°F) or too hot (above 100°F) adhesion may be impaired.

When to install:

- Installation should take place after construction is completed, flooring is installed and final cleaning is completed.
 - Paint on frame must be cured for at least 5-7 days. Paint cannot be wet under dry surface when gaskets are pressed on.
- Avoid quick-dry primers, which leave a powdery surface preventing sufficient adhesion. When applying to a wood frame, the surface must be non-porous and sealed. Follow standard industry guidelines on sealed wood frames and/or rough surface before applying. Note: Anti-bacterial, anti-fungal or silicone additives in paint may inhibit adhesion.

Application tips and warnings:

- Do NOT stretch material. Product can retract or shrink if stretched.
- Use very firm, perpendicular pressure when applying. Use wallpaper seam roller to reinforce adhesion after applying.
- Do not stretch material when using seam roller. Run roller with up and down motions.
- Double check adhesion after 2-3 hours before leaving job overnight.
- If gasket separates from frame, press again with firm pressure in place. If adhesive strip is exposed, airborne dust may impede adhesion. Replacement may be necessary.

- Application at header can be awkward due to overhead condition. Be sure to apply enough pressure.

NOTE: Adhesion takes delayed set. Immediate removal and resetting can be done if error occurs in initial placement.

DO NOT reset after one hour. Full set is reached in 24 hours.

1 1.1

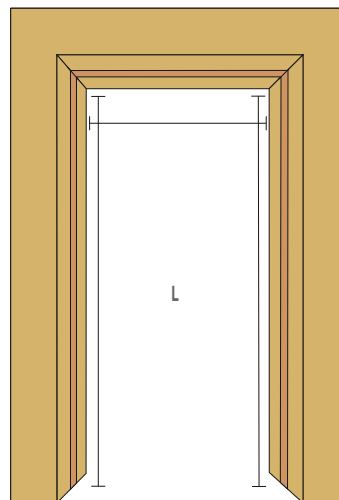

1.2



1.1 Measure height and width of door frame and cut seal to length.

1.2 Using a sharp knife cut the seal at a angle of 45° in the corners where the top and sides meet.

2

2.1

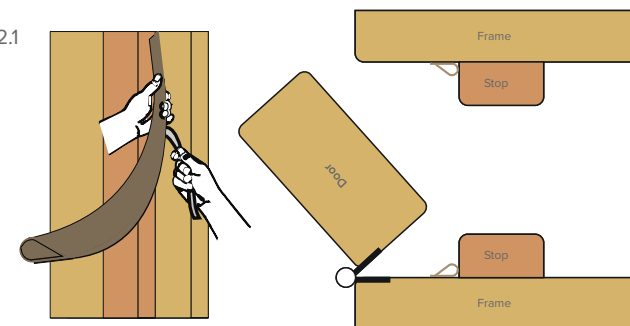

2.2

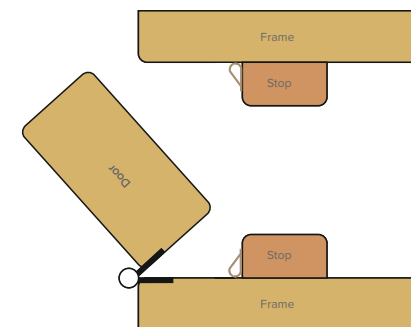

2.1 Remove approximately 600mm of the self adhesive backing from the seal. Position the seal as in 2.1 press firmly up and down the seal, repeat procedure until full length is applied. once installed apply firm pressure along the entire surface of the seal to ensure proper adhesion to the frame.

2.2 As an alternative you can attach the seal to the door stop as in 2.2